

## Technical Specifications

Product Model	OCuLink PCIe Adapter
Host Interface Types & Speeds	PCIe 3.0 x4: up to ~31.5 Gbps (32 GT/s)
Supported PCIe Slots	Works with x4, x8, or x16 PCIe 2.0, 3.0, 4.0, or 5.0 slots on motherboards
Host Data Connectors	One (1) PCIe connector
Client Data Connectors	One (1) SFF-8612 connector* (cable requires 85Ω impedance for PCIe/NVMe compatibility)
Supported Operating Systems	Windows 10 and 8.1 Windows Server 2019, 2016, 2012 and 2008 product families Linux distributions that support NVMe
Compliance	EMI Standard: FCC Part 15 Class B EMC Standard: EN55024, EN55032 CE, RoHS
Product Weight	0.8 oz (22.68 g)
Product Dimensions	4.02in L x 2.54in H (101.9mm L x 64.4mm H)
Technical Support	Your investment in CRU products is backed up by our free technical support for the lifetime of the product. Contact us through our website, <a href="https://www.cru-inc.com/support">cru-inc.com/support</a> or call us at 1-800-260-9800 or +1-360-816-1800.

\*Host port SFF-8612 mates with cable connector SFF-8611.

## Warnings & Notices

- The circuit boards within the product are susceptible to static electricity. Proper grounding is strongly recommended to prevent electrical damage to the product or other connected devices, including the computer host.
- Avoid placing the adapter close to magnetic devices, high voltage devices, or near a heat source. This includes any place where the product will be subject to direct sunlight. Do not allow water to make contact with the adapter.
- Before starting any type of hardware installation, please ensure that all power switches have been turned off and all power cords have been disconnected to prevent personal injury and damage to the hardware.
- When unplugging cables, **always** squeeze the cable's overmold (if it has one) to release the connector latches before unplugging the cable. Failure to do so may result in damage the latches on the cable and prevent it from latching securely in the future.
- The cable you use to connect a device to the SFF-8612 connector on the adapter requires 85Ω impedance for PCIe/NVMe compatibility.

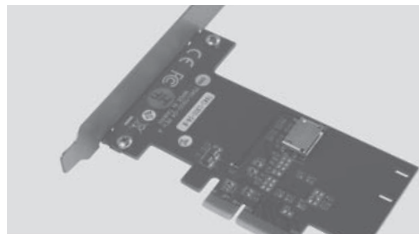

## OCuLink PCIe Adapter

## QUICK START GUIDE

## Package Contents

Item	Quantity
OCuLink PCIe Adapter	1
Low Profile Bracket	1
Quick Start Guide	1

## Identifying Parts

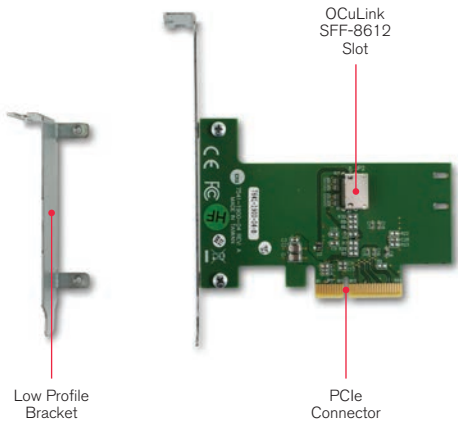

## Adapter Installation

- Install the OCuLink PCIe adapter into an open PCIe slot on your host computer.
- Insert the appropriate cable into the connector on your device.

### **STOP!**

To use this adapter with the CRU QX310, you will need to purchase the OCuLink SFF-8611 to SFF-8643-Male cable from the QX310 product page at [cru-inc.com](http://cru-inc.com). This cable has been optimized for performance. Longer cables or third-party cables may not work or may only work intermittently.

- Connect the other end of the cable to the OCuLink connector on the adapter.
- Turn on the computer.

Your OCuLink PCIe Adapter is now ready to use!

### **Technical Support**

Your investment in CRU products is backed up by our free technical support for the lifetime of the product. Contact us through our website, [cru-inc.com/support](http://cru-inc.com/support) or call us at 1-800-260-9800 or +1-360-816-1800.

### **Product Warranty**

CRU warrants this product to be free of significant defects in material and workmanship for a period of two (2) years from the original date of purchase. CRU's warranty is nontransferable and is limited to the original purchaser.

©2019 CRU Data Security Group LLC, ALL RIGHTS RESERVED. CRU® is a trademark of CRU Data Security Group, LLC and is protected by trademark law.

A9-000-0066-1 Rev. 1.0  
1000 SE Tech Center Dr. Suite 160, Vancouver, WA 98683